

Exploded Diagram

Main Assembly

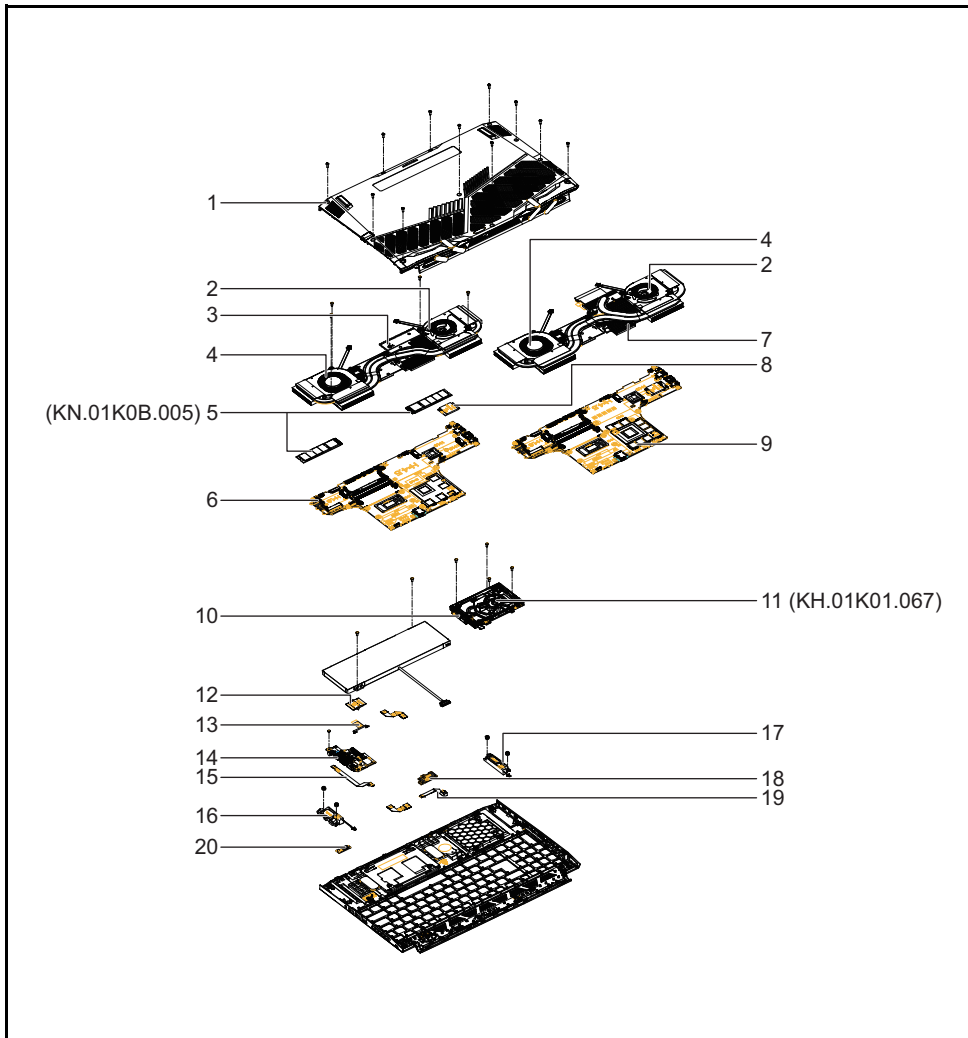

Figure 6-1. Main Assembly Exploded Diagram

Table 6-1. Main Assembly Exploded Diagram

No.	Description	AcerPN
1	LOWER CASE ASSY - BLACK	60.QC5N2.001
2	FAN FOR VGA	23.QC2N2.001
3	THERMAL MODULE DIS W/O FAN GN20-P1	24.QC5N2.001
4	FAN FOR CPU	23.QB9N2.001
5	Flash Disk SAMSUNG SSD NAND 1024GB SED PM9A1 MZVL21T0HCLR-00B07 LF+HF	KN.01K0B.005
6	Mainboard PH315-54 Intel GN20-P1 4GB CPU: Ci5 11400H GPU:GN20-P1 VRAM:4GB	NB.QC511.001

No.	Description	AcerPN
7	THERMAL MODULE DIS W/O FAN GN20-E3/E5/E7	24.QC2N2.001
8	Wireless LAN Intel 802.11ax Bluetooth FM Killer 1650i INTEL AX201.NGWG.NXXW WiFi 6 AX 2x2 HrP2 M.2+BT5.2 2230 CNVi NewOTP SKU	KE.11X0N.021
9	Mainboard PH315-54 Intel GN20-E5 8GB CPU:CI7 11800H GPU:GN20-E3 VRAM:8GB	NB.QC111.002
10	FFC CABLE FOR HDD	50.QC2N2.001
11	HDD SEAGATE 2.5" 7200rpm 1000GB ST1000LM049 , 2GH172-188 ,RosewoodX 1TB ,7mmzh HDD SATA III 128MB LF F/W:ACM1	KH.01K01.067
12	FFC CABLE FOR IO BOARD	50.QBAN2.001
13	WIRE CABLE FOR IO BOARD	50.Q7KN2.003
14	IO BOARD FOR VGA N18P-G61-A & GN20P0/P1	55.QB9N2.001
	IO BOARD FOR VGA GN20E SKU	55.QBAN2.001
15	FFC CABLE FOR SENSOR BOARD	50.QBTN2.001
16	SPEAKER L	23.Q7KN2.003
17	SPEAKER R	23.Q7KN2.004
18	TURBO KEY BOARD	55.QAUN2.001
19	FFC CABLE FOR TP	50.QBAN2.003
20	HALL SENSOR BOARD	55.QBAN2.002

Upper Case Assembly

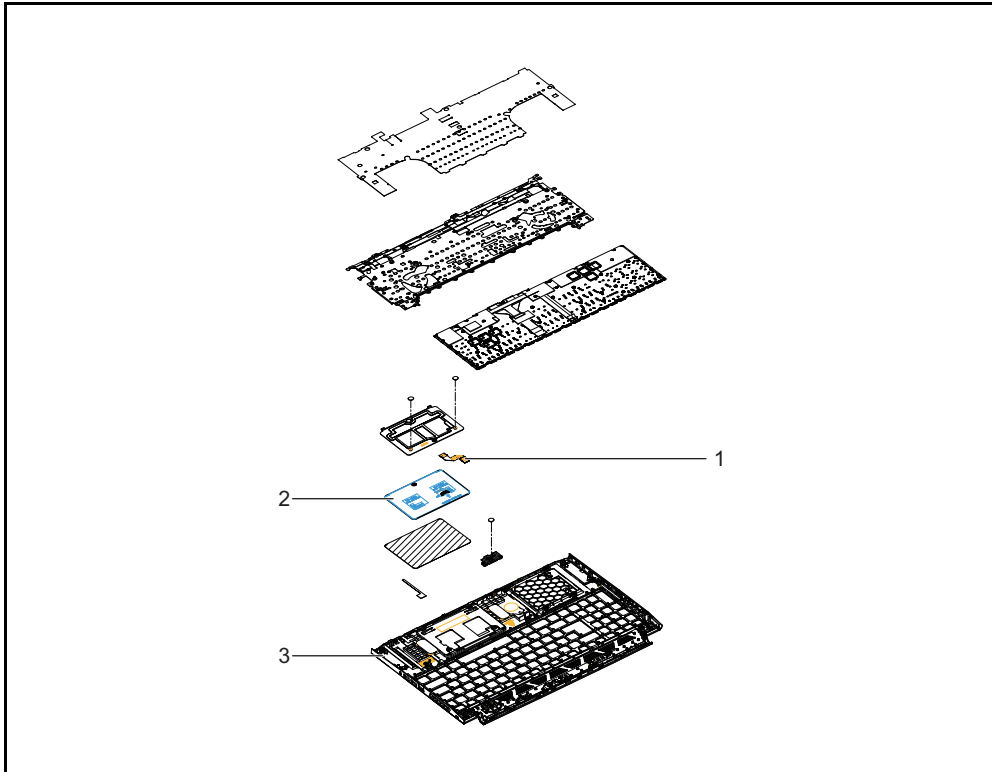

Figure 6-2. Upper Case Assembly Exploded Diagram

Table 6-2. Upper Case Assembly Exploded Diagram

No.	Description	AcerPN
1	FFC CABLE FOR TP	50.QBAN2.003
2	TOUCHPAD ASSY BLACK-SYNAPTICS, NC.24611.05J	56.Q7XN2.002
3	UPPER CASE ASSY BLACK W/BL RGB(Keyboard LG05P_P12B3L LG5P Internal 15 Standard 103KS Black US International Predator Font RGB 4-Zone V0 LED indicator,NK.I1513.1CX)	6B.QC5N2.001

LCD Assembly

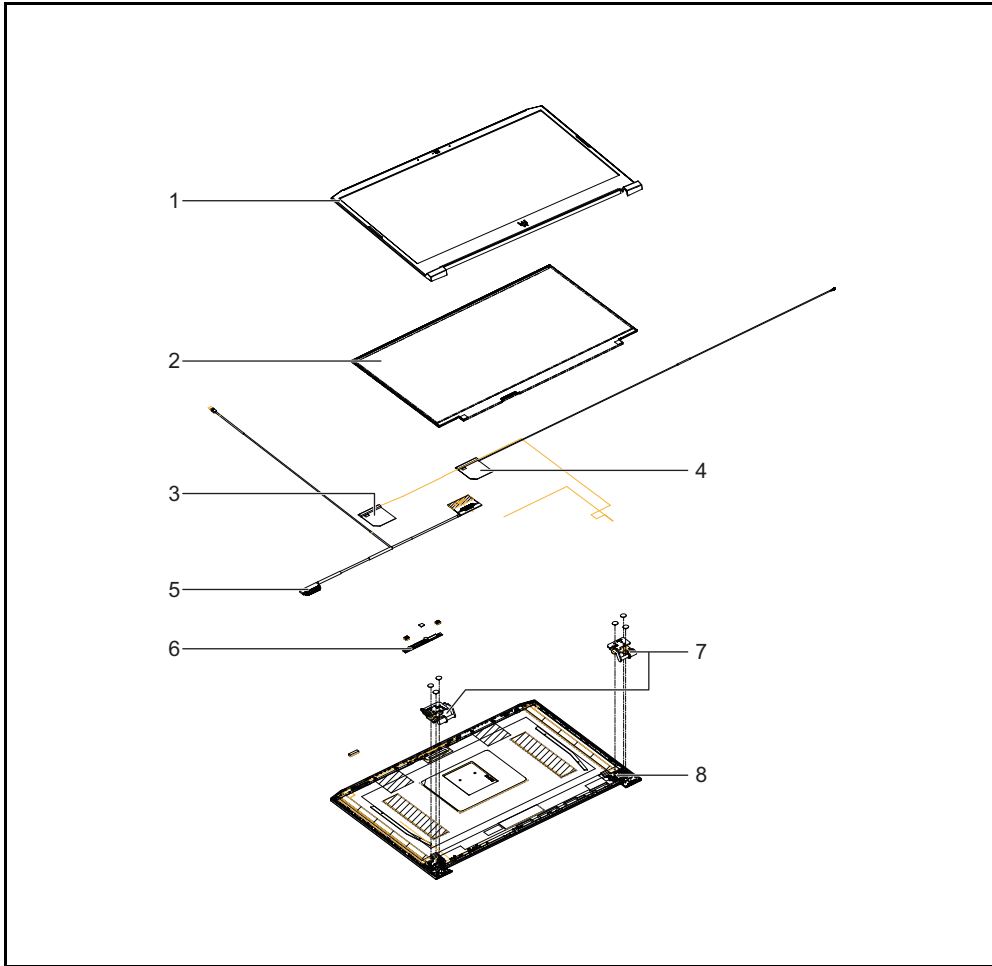



Figure 6-3. LCD Assembly Exploded Diagram
Table 6-3. LCD Assembly Exploded Diagram

No.	Description	AcerPN
1	LCD BEZEL BLACK FOR INDIA	60.QA3N2.001
2	LED LCD Panel LPL 15.6"W FHD None Glare LP156WFG-SPF3 LF 300nit 5ms GTG 800:1 (eDP,IPS,144Hz,OD 3ms GTG,narrow border,2.6t max)	KL.15608.041
3	ANTENNA WLAN - AUX	50.Q7XN2.002
4	ANTENNA WLAN - MAIN	50.Q7XN2.001
5	LCD EDP CABLE FOR 120 &144HZ	50.Q7WN2.002
6	Camera CHICONY HD Camera HD Camera CH_OV9734_RTS5846N_AOET_SPK0493 Unified2 (add Mic*2)	KS.0HD06.012
7	LCD HINGE R&L	33.Q7XN2.001
8	LCD COVER ASSY - BLACK FOR 2.6T	60.Q7XN2.003

FRU List

CATEGORY	Acer Description	AcerPN
ADAPTER		
	Adapter DELTA 180W 19.5V 1.7x5.5x11 ADP-180TB FR LF 210mm EMI core location,	KP.18001.008
	Adapter Chicony Power 180W 19.5V 1.7x5.5x11 A180A056P LF 210mm EMI core location	KP.1800H.002
	Adapter DELTA 230W 19.5V 1.7x5.5x11 ADP-230JB DA LF Black meet IEC 62368/CoC Tier2,core location 210mm	KP.23001.002
	Adapter Chicony Power 230W 19.5V 1.7x5.5x11 A230A033P LF Black Meet CoC Tler2 / IEC 62368	KP.2300H.004
BATTERY		
	Battery SIMPLO 3720mAh 4S1P AP18E7M 210x72x8.5(mm) AP18E 15.4V Polymer FW4.23	KT.00407.009
BOARD		
	IO BOARD FOR VGA N18P-G61-A & GN20P0/P1	55.QB9N2.001
	IO BOARD FOR VGA GN20E SKU	55.QBAN2.001
	HALL SENSOR BOARD	55.QBAN2.002
	TURBO KEY BOARD	55.QAUN2.001
CABLE		
	FFC CABLE FOR IO BOARD	50.QBAN2.001
	FFC CABLE FOR SENSOR BOARD	50.QBTN2.001
	WIRE CABLE FOR IO BOARD	50.Q7KN2.003

CATEGORY	Acer Description	AcerPN
	FFC CABLE FOR TP	50.QBAN2.003
	FFC CABLE FOR HDD	50.QC2N2.001
	FFC CABLE FOR TURBO KEY	50.QC5N2.001
	POWER CORD 1M BLACK SOUTH AFRICA - NEW	27.HEEN2.001
	POWER CORD 1M BLACK BLACK AUSTRALIA	27.Q28N2.002
	POWER CORD 1M BLACK EU	27.Q28N2.003
	POWER CORD 1M BLACK EU(New source)	27.Q7DN2.001
	POWER CORD 1M BLACK DENMARK	27.Q28N2.004
	POWER CORD 1M BLACK ISRAEL	27.Q28N2.005
	POWER CORD 1M BLACK ITALIAN	27.Q28N2.006
	POWER CORD 1M BLACK JAPAN	27.Q28N2.007
	POWER CORD 1M BLACK CHINA - NEW	27.HEEN2.002
	POWER CORD 1M BLACK INDIA	27.Q28N2.009
	POWER CORD 1M BLACK SWISS	27.Q28N2.010
	POWER CORD 1M BLACK UK	27.Q28N2.011
	POWER CORD 1M BLACK UK(New source)	27.Q7DN2.002
	POWER CORD 1M BLACK TWN	27.Q28N2.012
	POWER CORD 1M BLACK ARGENTINA - NEW	27.HEEN2.003
	POWER CORD 1M BLACK KOREA	27.Q28N2.014
	POWER CORD 1M BLACK US	27.Q28N2.015
	POWER CORD 1M BLACK US(New source)	27.Q7DN2.003
	POWER CORD 1M BLACK BRAZIL	27.Q28N2.016
	POWER CORD 1.8M 10A 250V BLACK AUS	27.Q1RN2.001
	POWER CORD 1.8M 10A 250V BLACK EUROPE	27.Q1RN2.002
	POWER CORD 1.8M 10A 250V BLACK DENMARK	27.Q1RN2.003
	POWER CORD 1.8M 10A 250V BLACK ITALY	27.Q1RN2.004

CATEGORY	Acer Description	AcerPN
	POWER CORD 1.8M 10A 250V BLACK CHINA	27.Q1RN2.005
	POWER CORD 1.8M 10A 250V BLACK INDIA	27.Q1RN2.006
	POWER CORD 1.8M 10A 250V BLACK SWISS	27.Q1RN2.007
	POWER CORD 1.8M 5A 250V BLACK UK	27.Q1RN2.008
	POWER CORD 1.8M 10A 250V BLACK US	27.Q1RN2.009
	POWER CORD 1.8M 7A 125V BLACK TAIWAN	27.Q1RN2.010
	POWER CORD 1.8M 10A 250V BLACK ARGENTINA	27.Q1RN2.011
	POWER CORD 1.8M 10A 250V BLACK BRAZIL	27.Q1RN2.012
	POWER CORD 1.8M 10A 250V BLACK AF	27.Q4VN2.001
	POWER CORD 1.8M 10A 250VBLACK ISRAEL	27.Q4VN2.002
	POWER CORD 1.8M 7A 125V BLACK Japanese	27.Q7XN2.001
	ANTENNA WLAN - MAIN	50.Q7XN2.001
	ANTENNA WLAN - AUX	50.Q7XN2.002
	LCD EDP CABLE FOR 120 &144HZ	50.Q7WN2.002
	LCD EDP CABLE FOR 165HZ	50.QC5N2.002
	LCD EDP CABLE FOR 360HZ	50.QC5N2.003
CAMERA		
	Camera CHICONY HD Camera HD Camera CH_OV9734_RTS5846N_AOET_SPK0493 Unified2 (add Mic*2)	KS.0HD06.012
	Camera Tech-Front HD Camera HD Camera TF_OV9734_SP2087L2_AOET_KMM4030 Unified2 (add Mic*2)	KS.0HD0Q.004
CASE/COVER/BRACKET ASSEMBLY		
	LOWER CASE ASSY - BLACK	60.QC5N2.001



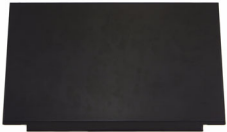

CATEGORY	Acer Description	AcerPN
	HDD BRACKET	33.Q7LN2.001
	LCD COVER ASSY - BLACK FOR 2.6T	60.Q7XN2.003
	LCD COVER ASSY - BLACK FOR 3.2T(PANDA)	60.Q7WN2.001
	LCD BEZEL BLACK FOR INDIA	60.QA3N2.001
	LCD HINGE R&L	33.Q7XN2.001
FAN		
	FAN FOR CPU	23.QB9N2.001
	FAN FOR VGA	23.QC2N2.001
HDD		
	HDD SEAGATE 2.5" 7200rpm 1000GB ST1000LM049 , 2GH172-188 ,RosewoodX 1TB ,7mmzh HDD SATA III 128MB LF F/W:ACM1	KH.01K01.067
	HDD WD 2.5" 7200rpm 1000GB WD10SPSX- 21A6WT0 , 7mmzh 1D , 1TB/P , MZ1000S SATA III LF F/W: 01.01A01	KH.01K08.040
	HDD WD 2.5" 5400rpm 2000GB WD20SPZX- 21UA7T0 , 7mmzh 2D , 1TB/P , MN1000M SATA III 128MB LF F/W:01.01A01	KH.02K08.020

CATEGORY	Acer Description	AcerPN
	Flash Disk SAMSUNG SSD NAND 1024GB SED PM9A1 MZVL21T0HCLR-00B07 LF+HF	KN.01K0B.005
	Flash Disk SAMSUNG SSD NAND 512GB SED PM9A1 MZVL2512HCJQ-00B07 LF+HF	KN.5120B.039
HEATSINK		
	THERMAL MODULE DIS W/O FAN GN20-P1	24.QC5N2.001
	THERMAL MODULE DIS W/O FAN GN20-E3/E5/E7	24.QC2N2.001
KEYBOARD ASSEMBLY		
	UPPER CASE ASSY BLACK W/BL RGB(Keyboard LG05P_P12B3L LG5P Internal 15 Standard 103KS Black US International Predator Font RGB 4-Zone V0 LED indicator,NK.I1513.1CX)	6B.QC5N2.001
	UPPER CASE ASSY BLACK W/BL RGB(Keyboard LG05P_P12B3L LG5P Internal 15 Standard 103KS Black Greek Predator Font RGB 4-Zone V0 LED indicator,NK.I1513.1CR)	6B.QC5N2.002
	UPPER CASE ASSY BLACK W/BL RGB(Keyboard LG05P_P12B3L LG5P Internal 15 Standard 103KS Black Arabic Predator Font RGB 4-Zone V0 LED indicator,NK.I1513.1CP)	6B.QC5N2.003
	UPPER CASE ASSY BLACK W/BL RGB(Keyboard LG05P_P12B3L LG5P Internal 15 Standard 103KS Black Traditional Chinese Predator Font RGB 4-Zone V0 LED indicator,NK.I1513.1CQ)	6B.QC5N2.004
	UPPER CASE ASSY BLACK W/BL RGB(Keyboard LG05P_P12B3L LG5P Internal 15 Standard 103KS Black Russian Predator Font RGB 4-Zone V0 LED indicator,NK.I1513.1CT)	6B.QC5N2.005
	UPPER CASE ASSY BLACK W/BL RGB(Keyboard LG05P_P12B3L LG5P Internal 15 Standard 103KS Black US International w/ Hebrew Predator Font RGB 4-Zone V0 LED indicator,NK.I1513.1CY)	6B.QC5N2.006
	UPPER CASE ASSY BLACK W/BL RGB(Keyboard LG05P_P12B3L LG5P Internal 15 Standard 103KS Black Thailand Predator Font RGB 4-Zone V0 LED indicator,NK.I1513.1CW)	6B.QC5N2.007

CATEGORY	Acer Description	AcerPN
	UPPER CASE ASSY BLACK W/BL RGB(Keyboard LG05P_P12B3L LG5P Internal 15 Standard 103KS Black Korean Predator Font RGB 4-Zone V0 LED indicator,NK.I1513.1CS)	6B.QC5N2.008
	UPPER CASE ASSY BLACK W/BL RGB(Keyboard LG05P_P12B3L LG5P Internal 15 Standard 103KS Black Ukrainian Predator Font RGB 4-Zone V0 LED indicator,NK.I1513.1CU)	6B.QC5N2.009
	UPPER CASE ASSY BLACK W/BL RGB(Keyboard LG05P_P12B3L LG5P Internal 15 Standard 103KS Black Persian Predator Font RGB 4-Zone V0 LED indicator,NK.I1513.1CV)	6B.QC5N2.010
	UPPER CASE ASSY BLACK W/BL RGB(Keyboard LG05P_P12B3L LG5P Internal 15 Standard 103KS Black US International w/ Canadian French Predator Font RGB 4-Zone V0 LED indicator,NK.I1513.1CZ)	6B.QC5N2.011
	UPPER CASE ASSY BLACK W/BL RGB(Keyboard LG05P_P12B3L LG5P Internal 15 Standard 103KS Black US International w/ Bulgaria Predator Font RGB 4-Zone V0 LED indicator,NK.I1513.1D0)	6B.QC5N2.012
	UPPER CASE ASSY BLACK W/BL RGB(Keyboard LG05P_P12B3L LG5P Internal 15 Standard 104KS Black UK Predator Font RGB 4- Zone V0 LED indicator,NK.I1513.1DK)	6B.QC5N2.013
	UPPER CASE ASSY BLACK W/BL RGB(Keyboard LG05P_P12B3L LG5P Internal 15 Standard 104KS Black German Predator Font RGB 4-Zone V0 LED indicator,NK.I1513.1D8)	6B.QC5N2.014
	UPPER CASE ASSY BLACK W/BL RGB(Keyboard LG05P_P12B3L LG5P Internal 15 Standard 104KS Black Swiss/G Predator Font RGB 4-Zone V0 LED indicator,NK.I1513.1DH)	6B.QC5N2.015
	UPPER CASE ASSY BLACK W/BL RGB(Keyboard LG05P_P12B3L LG5P Internal 15 Standard 104KS Black Belgium Predator Font RGB 4-Zone V0 LED indicator,NK.I1513.1D2)	6B.QC5N2.016
	UPPER CASE ASSY BLACK W/BL RGB(Keyboard LG05P_P12B3L LG5P Internal 15 Standard 104KS Black Danish Predator Font RGB 4-Zone V0 LED indicator,NK.I1513.1D5)	6B.QC5N2.017
UPPER CASE ASSY BLACK W/BL RGB(Keyboard LG05P_P12B3L LG5P Internal 15 Standard 104KS Black Italian Predator Font RGB 4-Zone V0 LED indicator,NK.I1513.1DA)	6B.QC5N2.018	

CATEGORY	Acer Description	AcerPN
	UPPER CASE ASSY BLACK W/BL RGB(Keyboard LG05P_P12B3L LG5P Internal 15 Standard 104KS Black Brazilian Portuguese Predator Font RGB 4-Zone V0 LED indicator,NK.I1513.1D3)	6B.QC5N2.030
	UPPER CASE ASSY BLACK W/BL RGB(Keyboard LG05P_P12B3L LG5P Internal 15 Standard 104KS Black ALA-Spanish Predator Font RGB 4-Zone V0 LED indicator,NK.I1513.1D1)	6B.QC5N2.031
	UPPER CASE ASSY BLACK W/BL RGB(Keyboard LG05P_P12BJP LG5P Internal 15 Standard 107KS Black Japanese Predator Font RGB 4-Zone JP V0 LED indicator,NK.I1513.1EL)	6B.QC5N2.032
LCD		
	LED LCD Panel LPL 15.6"W FHD None Glare LP156WFG-SPF3 LF 300nit 5ms GTG 800:1 (eDP,IPS,144Hz,OD 3ms GTG,narrow border,2.6t max)	KL.15608.041
	LED LCD Panel BOE 15.6"W FHD None Glare NV156FHM-N4K v3.2 LF 300nit 9ms 1200:1 (eDP,IPS,144Hz,OD 3ms GTG,narrow border,2.6t max)	KL.1560E.019
	LED LCD Panel AUO 15.6"W FHD None Glare B156HAN09.2 LF 300nit 9ms 1000:1 (eDP,IPS,144Hz,OD 3ms GTG,narrow border,2.6t max)	KL.15605.063
	LED LCD Panel AUO 15.6"W FHD None Glare B156HAN08.4 LF 250nit 25ms 800:1 (eDP, value IPS, narrow border, 144Hz)	KL.15605.066
	LED LCD Panel CMI 15.6"W FHD None Glare N156HRA-EA1 C1 LF 250nit 25ms 800:1 (eDP, value IPS, narrow border, 3.2mm max, 144Hz)	KL.1560D.044
	LED LCD Panel BOE 15.6"W QHD None Glare NE156QHM-NY3 LF 300nit 9ms 1000:1 (eDP,IPS,165Hz,OD 3ms GTG,narrow border,2.6t max)	KL.1560E.029
	LED LCD Panel INNOLUX 15.6"W QHD None Glare N156KME-GNA C1 LF 300nit 3ms GTG 1000:1 (eDP,IPS,165Hz,OD 3ms GTG,narrow,DCI- P3, 2.6t max)	KL.1560D.049
	LED LCD Panel BOE 15.6"W QHD None Glare NE156QHM-NY5 LF 300nit 9ms 1000:1 (eDP,IPS,165Hz,OD 3ms GTG,narrow,DCI-P3, 2.6t max)	KL.1560E.031

CATEGORY	Acer Description	AcerPN
	LED LCD Panel BOE 15.6'W FHD None Glare NE156FHM-NZ3 LF 300nit 9ms 1000:1 (eDP,IPS,360Hz,OD 3ms GTG, narrow,2.6t max)	KL.1560E.030
MAINBOARD		
 	Mainboard PH315-54 Intel GN20-P1 4GB CPU: Ci5 11400H GPU:GN20-P1 VRAM:4GB	NB.QC511.001
	Mainboard PH315-54 Intel GN20-P1 4GB	NB.QC511.002
	Mainboard PH315-54 Intel GN20-E3 6GB	NB.QC211.001
	Mainboard PH315-54 Intel GN20-E3 6GB CPU: Ci7 11800H GPU:GN20-E3 VRAM:6GB	NB.QC211.002
	Mainboard PH315-54 Intel GN20-E5 8GB CPU: Ci5 11400H GPU:GN20-E5 VRAM:8GB	NB.QC111.001
	Mainboard PH315-54 Intel GN20-E5 8GB CPU: Ci7 11800H GPU:GN20-E3 VRAM:8GB	NB.QC111.002
MEMORY		
	Memory SAMSUNG SO-DIMM DDRIV 3200 4GB M471A5244CB0-CWE LF+HF 512*16 18nm C-die	KN.4GB0B.052
	Memory HYNIX SO-DIMM DDRIV 3200 4GB HMA851S6DJR6N-XN LF+HF 512*16 DA	KN.4GB0G.054
	Memory MICRON SO-DIMM DDRIV 3200 8GB MTA4ATF1G64HZ-3G2E1 LF+HF 1024*16 Z32D	KN.8GB04.048
	Memory KINGSTON SO-DIMM DDRIV 3200 8GB ACR32D4S2S1ME-8 LF+HF 1024*16 MI-E	KN.8GB07.056
	Memory HYNIX SO-DIMM DDRIV 3200 8GB HMAA1GS6CJR6N-XN LF+HF 1024*16 RG C-die	KN.8GB0G.073
	Memory KINGSTON SO-DIMM DDRIV 3200 16GB ACR32D4S2S8ME-16 LF+HF MI-E	KN.16G07.033
	Memory SAMSUNG SO-DIMM DDRIV 3200 16GB M471A2K43EB1-CWE LF+HF 1024*8 1znm E-die	KN.16G0B.035
	Memory HYNIX SO-DIMM DDRIV 3200 16GB HMAA2GS6CJR8N-XN LF+HF 1024*16 RG C-die	KN.16G0G.036
MISCELLANEOUS		
	RUBBER FOR MIS	47.Q7KN2.001
	CONDUCTIVE TAPE FOR TP	47.Q8FN2.001
	LCD PANEL ADHESIVE FOR 3.2T	47.Q7XN2.001
	LCD PANEL ADHESIVE FOR 2.6T	47.Q7XN2.002
	LCD ALIGNMENT MYLAR 10x5x0.4mm	47.Q55N2.002

CATEGORY	Acer Description	AcerPN
POINT DEVICE		
	TOUCHPAD ASSY BLACK-SYNAPTICS, NC.24611.05J	56.Q7XN2.002
	TOUCHPAD ASSY BLACK-ELANTECH, NC.24611.06H	56.QC5N2.001
SPEAKER		
	SPEAKER L	23.Q7KN2.003
	SPEAKER R	23.Q7KN2.004
WIRELESS LAN		
	Wireless LAN Intel 802.11ax Bluetooth FM Killer 1650i INTEL AX201.NGWG.NXXW WiFi 6 AX 2x2 HrP2 M.2+BT5.2 2230 CNVi NewOTP SKU	KE.11X0N.021

Screw List

CATEGORY	Description	Part No.
SCREWS		
	SCREW 2.0D 2.5L K 5D 0.5T NI NL	86.H14N2.001
	SCREW 2.5D 2.5L K 8D 0.6T ZK NL	86.H14N2.002
	SCREW 2.5D 5.0L K 4.6D NI NL	86.H14N2.003
	SCREW 2.5D 6L K 4.6D .8T BNI-ZN NL	86.Q5EN2.001
	SCREW M M 2.0D 4.0L K 4.6D BNI NL	86.Q99N2.001
	SCREW 3.0D 4.0L K 4.6D BNI	86.HZWN2.001